

<RoHS Compliance>

CP-2UN CP-2UTN

FEATURES

- Substitute model of CP-2UX and CP-2UTX
- Low current consumption
- Compact & light weight
- Low torque

Electrical Specifications

Electrical Angle	$\pm 45^\circ$
Output Sensitivity	2%Vin/10° MIN.
Independent Linearity	$\pm 2\%FS$ (FS=90°)
Input Impedance	14K Ω $\pm 5.0\%$ (7~21K Ω)
Input Voltage	DC 1.0 V MAX.
Load Resistance	5M Ω MIN.

Mechanical Specification

Mechanical Angle	360° Endless
Torque	0.05mN · m MAX.
Weight	Approx.10g
Shaft Radial Load	5N
Shaft Thrust Load	1N

Environmental Specification

Vibration	200m/S ² 3axes 2hours each
Shock	1000m/S ² 3Axis 6Directions 3Times each
Operating Temp.	-40~100°C
Storage Temp.	-40~100°C

OPTIONS

- Built-in Temp Compensate Resistance

Temp. Compensating Range & Temp. Characteristics

	TCA	TCB	TCC
Temp. Range	0~60°C	-20~80°C	-30~100°C
At 0°	$\pm 0.5^\circ$	$\pm 0.5^\circ$	$\pm 0.8^\circ$
At $\pm 45^\circ$	$\pm 3.5^\circ$	$\pm 6^\circ$	$\pm 8^\circ$

DIMENSION

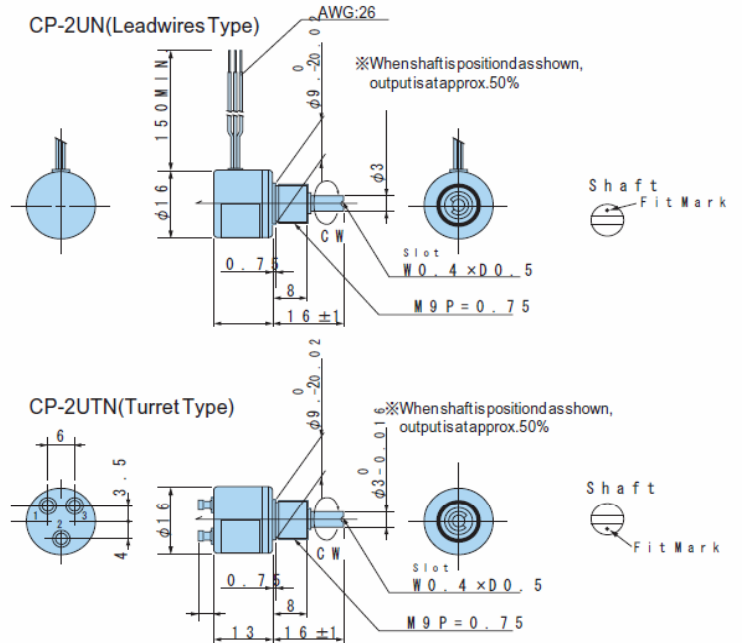

MOUNTING

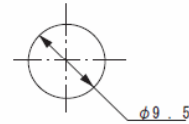

SCHEMATIC

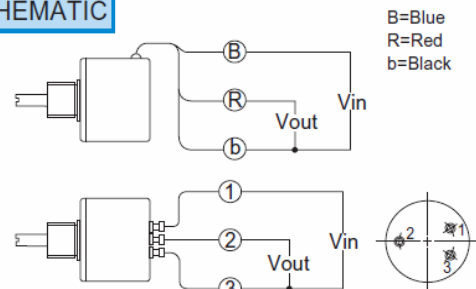

OUTPUT CHARACTERISTICS

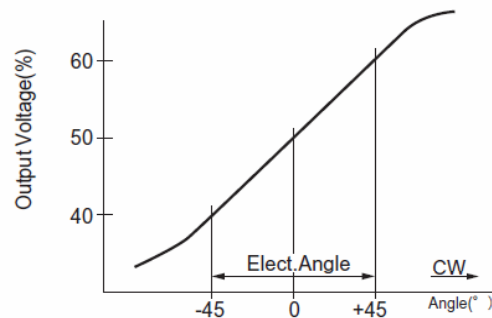

MOUNTING HARDWARE

M 9 nut, Lock Washer