

## <RoHS Compliance> CP-2UKN-A

### FEATURES

- Substitution model of CP-2UK-A200
- Built-in Temp Compensate Resistance
- Built-in Current Output Amplifier

### Electrical Specifications

Electrical Angle	±45°
Output Range	4~20mA
Independent Linearity	±2.2%FS (FS=90°)
Input Voltage	DC 24±4V
Load Resistance	600Ω MAX.(At 24Vin)
Temp. Characterisitcs	0° Position ±1.3° ±45° Position ±3°

### Mechanical Specification

Mechanical Angle	360° Endless
Torque	2mN · m MAX.
Weight	Approx.80g
Shaft Radial Load	14N
Shaft Thrust Load	4N

### Enviromental Specification

Life Cycle	500M Cycle MIN.
Vibration	100m/S , 3 axis 2hours each
Shock	1000m/S , 3 axis 6directions 3times each
EMS	IEC61000-4-3, Level 3 (10V/m)
Operating Temp.	-20~80°C
Storage Temp.	-40~100°C
ESD(Case~Each Terminal)	±4kV
ESD(Each Terminal)	±4kV
IP Level	IP54 Excluding Seal Between Shaft and Bushing

### DIMENSION ( m m )

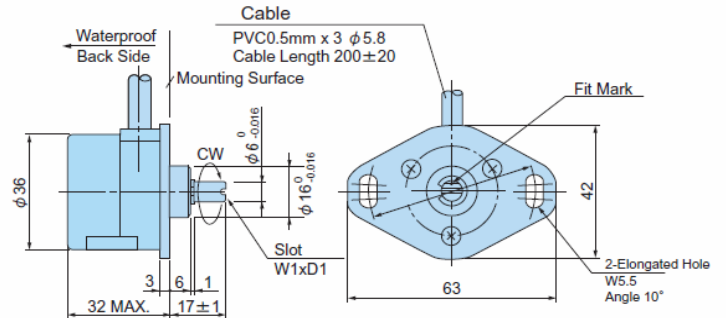

※When Shaft is positioned as shown, output is at approx. 12mA.

### MOUNTING

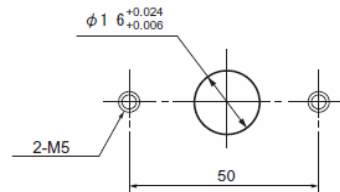

### SCHEMATIC

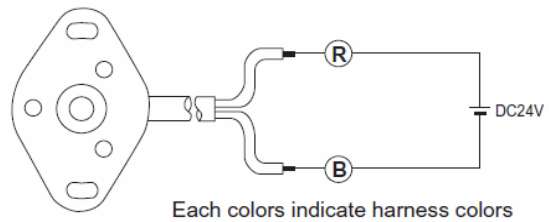

### OUTPUT CHARACTERISTICS

